



# INSTRUCTION BULLETIN

No. 340255  
Machine: 6200  
Published: 12-99/01  
System: OPTIONS

**NOTE: DO NOT DISCARD the Parts List from the Instruction Bulletin. Place the Parts List in the appropriate place in your machine manual for future reference. Retaining the Parts List will make it easier to reorder individual parts and will save you the cost of ordering an entire kit.**

*NOTE: Numbers in parenthesis ( ) are reference numbers for parts listed in Bill of Materials.*

Installation instructions for kit numbers 384137 thru 384139

## **SYNOPSIS / PROBLEM:**

This kit contains the parts needed to install flashing or revolving light kits on the model 6200 12V sweeper.

Please follow step-by-step instructions.

## **SPECIAL TOOLS / CONSIDERATIONS: NONE**

(Estimated time to complete: 1 hour)

## **PREPARATION:**

(Refer to FIG. 1, 2 and 3)

**FOR SAFETY: Before leaving or servicing machine, stop on level surface and set parking brake. Then turn off machine and remove key.**

1. Disconnect battery cables from machine.



**WARNING: Always disconnect battery cables from machine before working on electrical components.**

## **INSTALLATION:**

(Refer to FIG. 1, 2 and 3)

*NOTE: If your machine is already equipped with the operating headlight / taillight package, proceed to step number 5. Keep switch 360520 and circuit breaker 383722 as spare parts.*

1. Open the circuit breaker panel.
2. Install the new circuit breaker (10) in the panel. Wire the circuit breaker (10) into the main harness. (Refer to FIG. 1, 2 and 3)
3. Remove the standard light switch in the control panel, and unplug it from the wiring harness. (Refer to FIG. 1, 2 and 3)
4. Plug the new switch (11) into the wiring harness, and snap it into place in the control panel. (Refer to FIG. 1, 2 and 3)
5. Check that the grommet (7) is secured in the top of the light angle mounting plate (5). (Refer to FIG. 1 and 2)

6. Mount the light angle mounting plate (5) to the left side of the machine with two hex screws (6) and washers (4). (Refer to FIG. 1 and 2)
7. Run the light wiring connections through the grommet (7) in the top of the light angle mounting plate (5). Connect the light wiring to the warning light/ backup alarm harness. (Refer to FIG. 1, 2 and 3)
8. Connect the warning light/ backup alarm harness to the main harness. Bundle and secure any excess harness to the light angle mounting plate with the cable tie (9) and cable tie mount (8). (Refer to FIG. 1, 2 and 3)
9. Turn the machine power on, and check the warning light for proper operation.
10. Mount the lamp guard (2) to the top of the light angle mounting plate (5) with four hex screws (3) and washers (4). (Refer to FIG. 1 and 2)

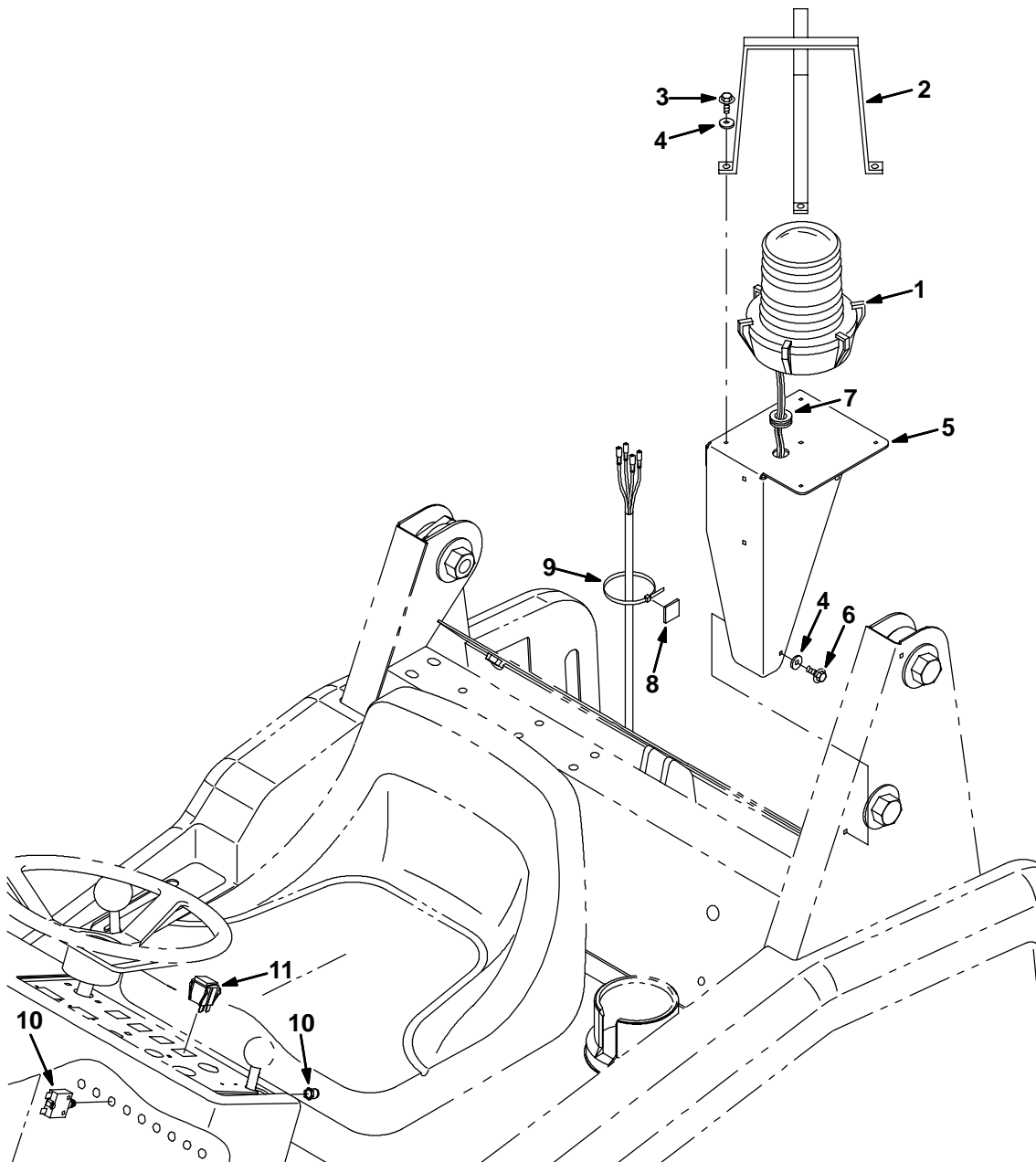

**FIG. 1 - FLASHING LIGHT KIT 384137 INSTALLATION**

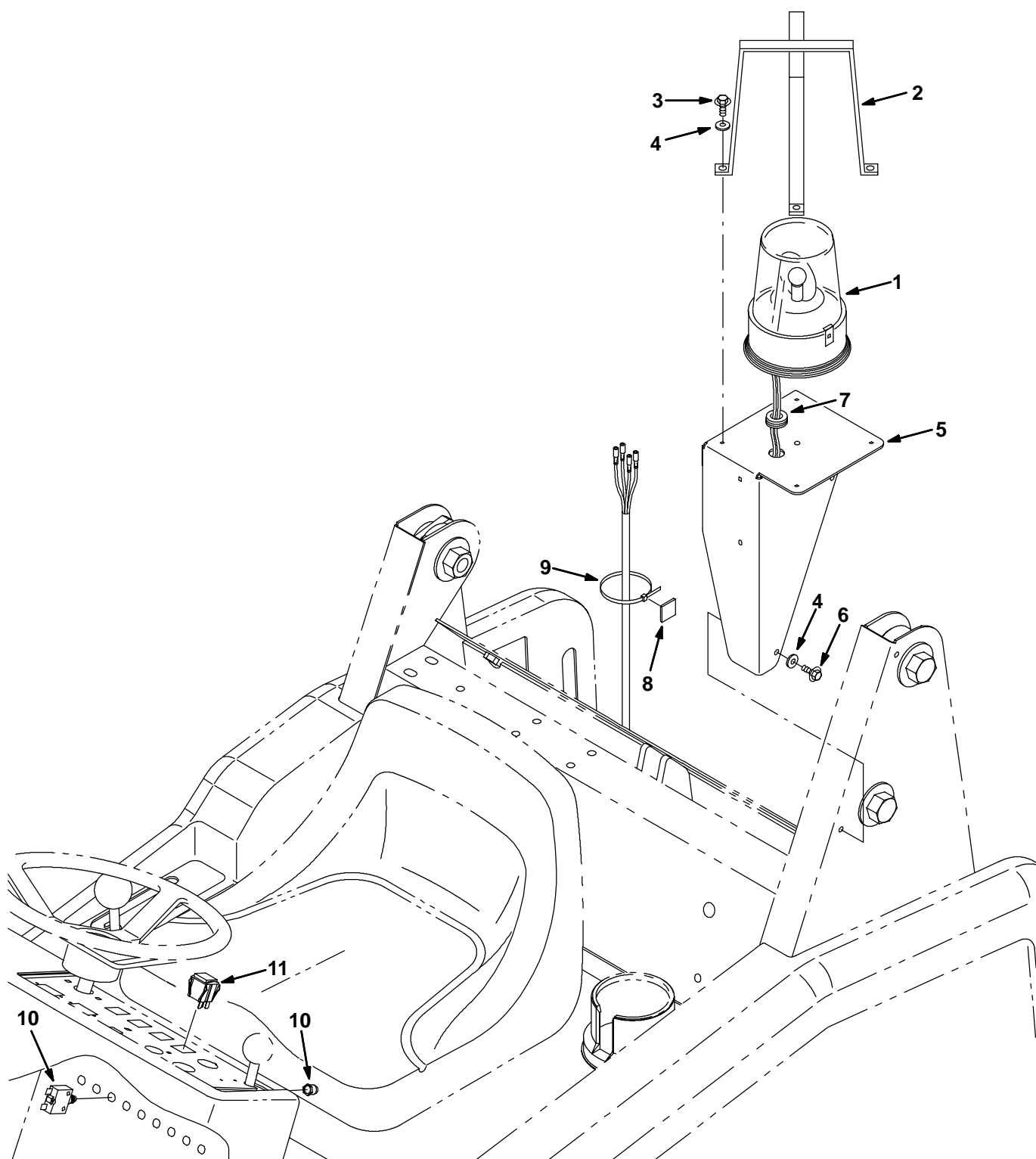

**FIG. 2 - REVOLVING LIGHT KIT 384139 INSTALLATION**

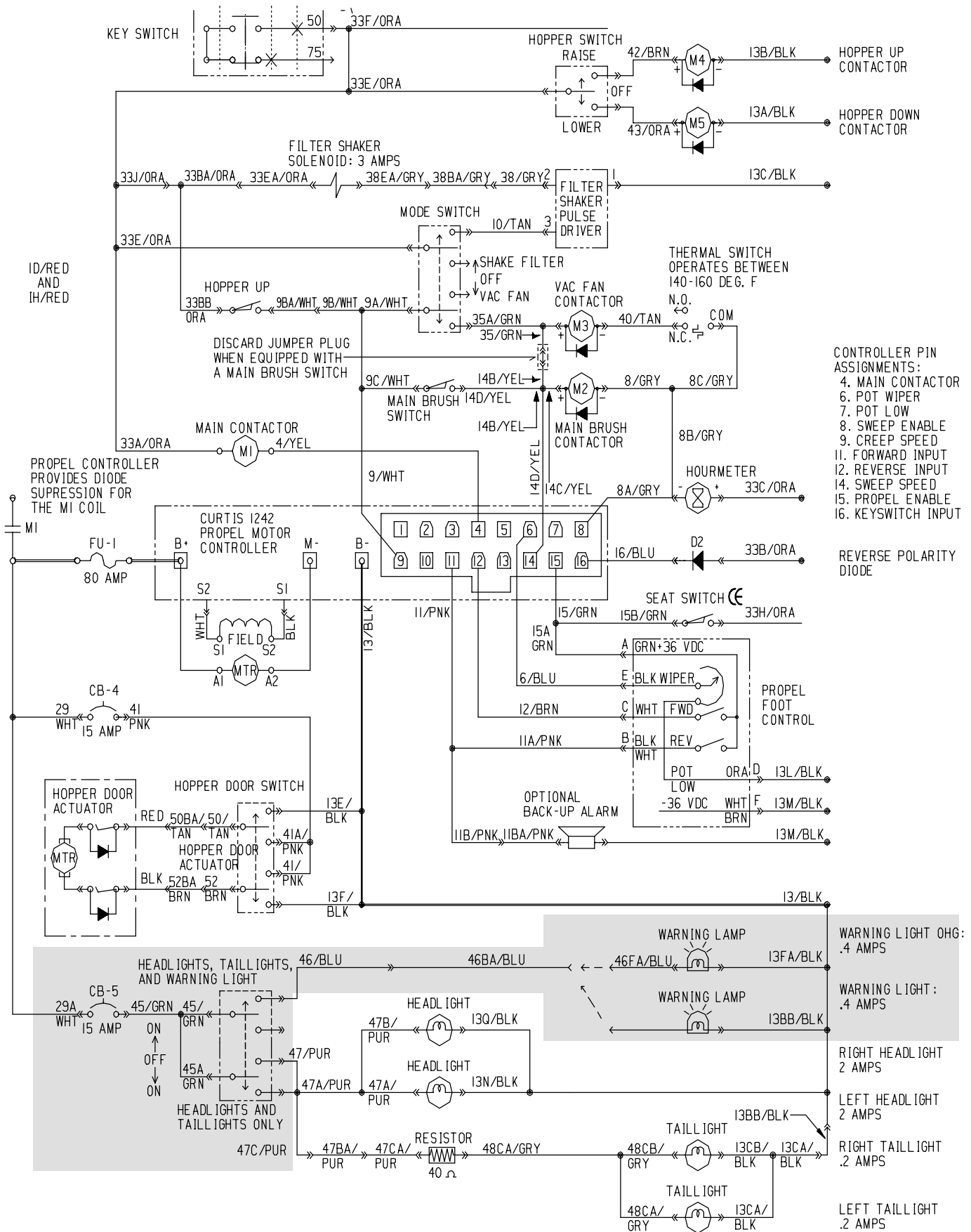

**FIG. 3 - 6200 WIRING SCHEMATIC**

**BILL OF MATERIALS FOR FLASHING LIGHT KIT 384137**

<b>Ref.</b>	<b>TENNANT Part No.</b>	<b>Description</b>	<b>Qty.</b>
1	02255	Lamp, Flsh, Amb, 12Vdc	1
2	45272	Guard, Lamp	1
3	12459	Screw, Hex, Fmg, M06-1.0 X 20	4
4	32490	Washer, Flat, .25 Hard	6
5	384165	Angle, Mtg, Light	1
6	361339	Screw, Hex 6 X 1.0 16 Pltd	2
7	10632-2	Grommet, Rubber	1
8	55248	Mount, Cable Tie	1
9	49266	Tie, Cable 1.75D Max 7.50Lg	1
10	383722	Circuitbreaker, 15Amp	1
11	360520	Switch, Rocker, Spdt, 3Pos	1

**BILL OF MATERIALS FOR REVOLVING LIGHT KIT 384139**

<b>Ref.</b>	<b>TENNANT Part No.</b>	<b>Description</b>	<b>Qty.</b>
1	383980	Lamp, Revl, Amb, 12V	1
2	45272	Guard, Lamp	1
3	12459	Screw, Hex, Fmg, M06-1.0 X 20	4
4	32490	Washer, Flat, .25 Hard	6
5	384165	Angle, Mtg, Light	1
6	361339	Screw, Hex 6 X 1.0 16 Pltd	2
7	10632-2	Grommet, Rubber	1
8	55248	Mount, Cable Tie	1
9	49266	Tie, Cable 1.75D Max 7.50Lg	1
10	383722	Circuitbreaker, 15Amp	1
11	360520	Switch, Rocker, Spdt, 3Pos	1

TENNANT COMPANY  
P. O. Box 1452  
Minneapolis, MN 55440-1452